

Title Number : CB330689

This title is dealt with by Land Registry, Peterborough Office.

The following extract contains information taken from the register of the above title number. A full copy of the register accompanies this document and you should read that in order to be sure that these brief details are complete.

Neither this extract nor the full copy is an 'Official Copy' of the register. An official copy of the register is admissible in evidence in a court to the same extent as the original. A person is entitled to be indemnified by the registrar if he or she suffers loss by reason of a mistake in an official copy.

This extract shows information current on 10 OCT 2013 at 15:09:22 and so does not take account of any application made after that time even if pending in the Land Registry when this extract was issued.

REGISTER EXTRACT

Title Number	: CB330689
Address of Property	: land on the north side of Hall Lane, Great Chishill
Price Stated	: Not Available
Registered Owner(s)	: GREAT CHISHILL PARISH COUNCIL care of Mrs Sarah Scott, Chishill Cottage, 17 Hall Lane, Great Chishill, Cambridgeshire SG8 8SG.
Lender(s)	: None

Title number CB330689

This is a copy of the register of the title number set out immediately below, showing the entries in the register on 10 OCT 2013 at 15:09:22. This copy does not take account of any application made after that time even if still pending in the Land Registry when this copy was issued.

This copy is not an 'Official Copy' of the register. An official copy of the register is admissible in evidence in a court to the same extent as the original. A person is entitled to be indemnified by the registrar if he or she suffers loss by reason of a mistake in an official copy. If you want to obtain an official copy, the Land Registry web site explains how to do this.

A: Property Register

This register describes the land and estate comprised in the title.

CAMBRIDGESHIRE : SOUTH CAMBRIDGESHIRE

- 1 (17.01.2008) The Freehold land shown edged with red on the plan of the above title filed at the Registry and being land on the north side of Hall Lane, Great Chishill.

B: Proprietorship Register

This register specifies the class of title and identifies the owner. It contains any entries that affect the right of disposal.

Title absolute

- 1 (17.01.2008) PROPRIETOR: GREAT CHISHILL PARISH COUNCIL care of Mrs Sarah Scott, Chishill Cottage, 17 Hall Lane, Great Chishill, Cambridgeshire SG8 8SG.
- 2 (17.01.2008) The value as at 17 January 2008 was stated to be under £100,000.
- 3 (02.03.2010) The proprietor's address for service has been changed.

C: Charges Register

This register contains any charges and other matters that affect the land.

- 1 (17.01.2008) A Conveyance of the land in this title dated 28 July 1949 made between (1) Charles Hubert Archbald Butler and (2) The Parish Council Of The Parish Of Great Chishill contains restrictive covenants.

NOTE: Copy filed.

- 2 (17.01.2008) By a Deed dated 10 January 1979 made between (1) Hubert Arthur James Butler and Gildart John Russell Butler and (2) The Parish Council Of The Parish Of Great Chishill the covenants contained in the Conveyance dated 28 July 1949 referred to above were expressed to be released as to part.

NOTE: Copy filed.

End of register

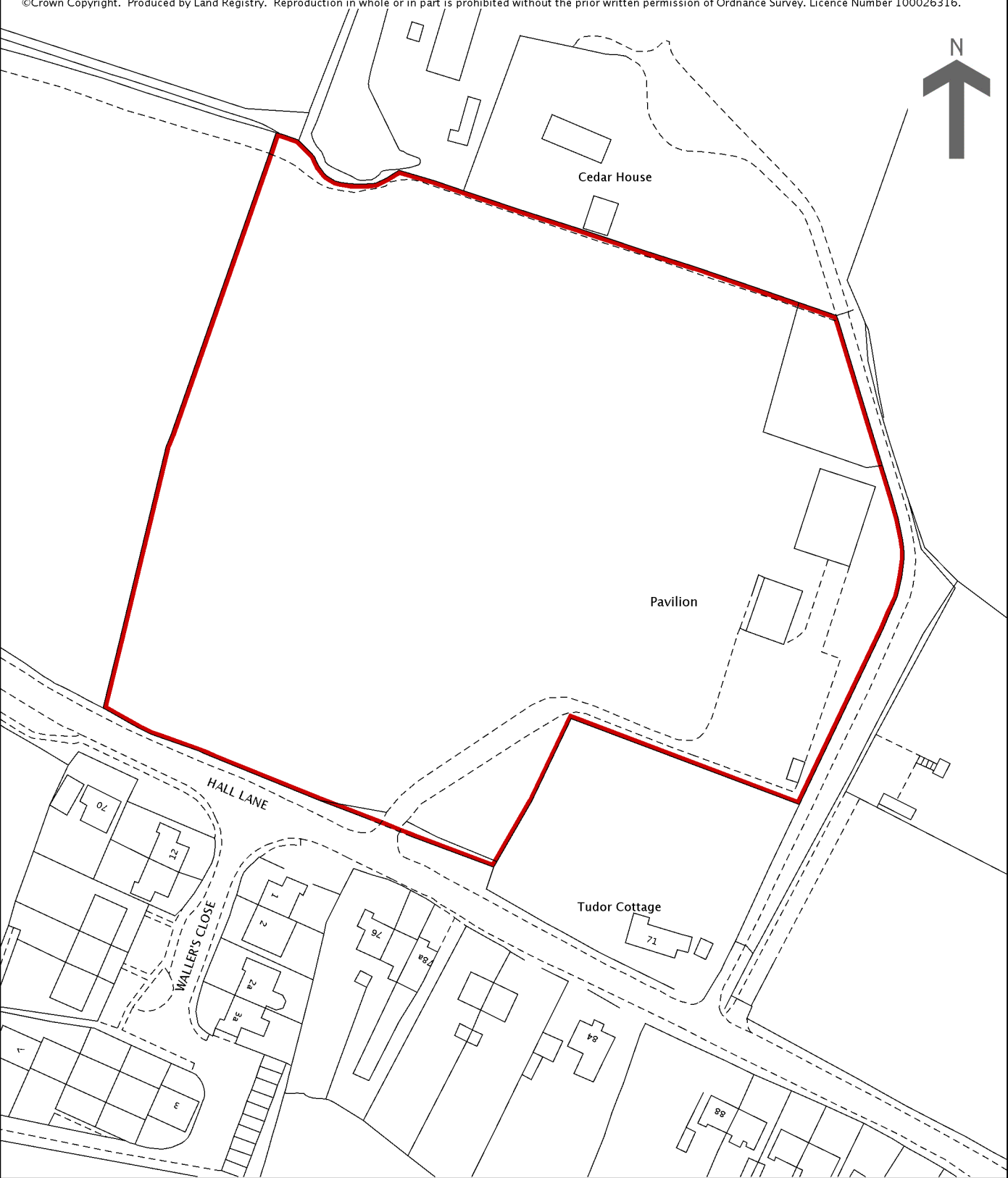
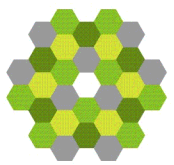

This is a copy of the title plan on 10 OCT 2013 at 15:09:22. This copy does not take account of any application made after that time even if still pending in the Land Registry when this copy was issued.

This copy is not an 'Official Copy' of the title plan. An official copy of the title plan is admissible in evidence in a court to the same extent as the original. A person is entitled to be indemnified by the registrar if he or she suffers loss by reason of a mistake in an official copy. If you want to obtain an official copy, the Land Registry web site explains how to do this.

The Land Registry endeavours to maintain high quality and scale accuracy of title plan images. The quality and accuracy of any print will depend on your printer, your computer and its print settings. This title plan shows the general position, not the exact line, of the boundaries. It may be subject to distortions in scale. Measurements scaled from this plan may not match measurements between the same points on the ground. See Land Registry Public Guide 19 - Title plans and boundaries.

This title is dealt with by Land Registry, Peterborough Office.